

3M™ Speedglas™ Welding Helmet 9100 FX



To optimise the effective lifetime of your welding equipment and avoid the additional cost of replacement, regular maintenance is important. Replace all damaged parts immediately to ensure correct levels of protection.

Before use

- Helmet and head harness. Inspect for cracks or any damaged or defective parts. Replace if needed.
- Cover lenses and visor. To provide the best possible vision they should be clean and without scratches.
- Welding lens. Ensure low battery is not flashing and check that the sensors are clean and uncovered.

After use

- Clean the helmet. Wipe with a moist tissue or cloth, both inside and outside the helmet. If you suspect that the inside of the airduct is dirty, it must be changed. DO NOT rinse, immerse in water or clean with solvents.
- Sweatband. Remove for additional cleaning as needed and replace if they become unhygienic.
- Cover lenses and visor plate. Clean with a soft cloth and replace if any pits or scratches occur.
- Storage. Store the helmet in a dry, clean area away from direct sunlight, high temperatures and solvents.

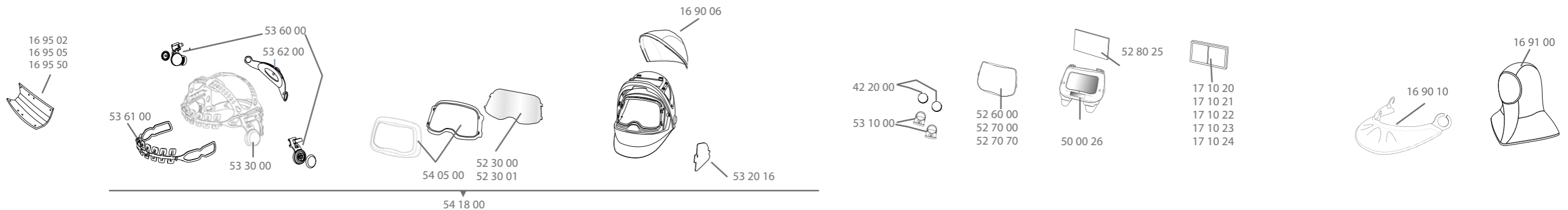

Part No	Description	Part No	Description	Part No	Description	Part No	Description	Part No	Description
169006	HEAD COVER SMALL 9100 FX	171020	LENS MAGNIFYING 1.0X 9100 100 & 9000	523000	VISOR PLATE 9100 FX PK=5	532016	SIDEWINDOWS COVER PLATE 9100 FX PK=2		
169007	HEAD COVER LARGE 9100 FX	171021	LENS MAGNIFYING 1.5X 9100 100 & 9000	523001	VISOR PLATE ANTI-FOG 9100 FX PK=5	533000	HEAD HARNESS 9100		
169010	THROAT PROTECTION 9100	171022	LENS MAGNIFYING 2.0X 9100 100 & 9000	526000	LENS COVER OUTER STD 9100 PK=10	536000	HEAD HARNESS PIVOT MECHANISM 9100		
169100	HEAD CAPE TECAWELD	171023	LENS MAGNIFYING 2.5X 9100 100 & 9000	527000	COVER LENS OUTER HC 9100 PK=10	536100	HEAD HARNESS FRONT PART 9100		
169502	SWEATBAND 9100 & 9100 FX PK=2	171024	LENS MAGNIFYING 3.0X 9100 100 & 9000	527070	LENS COVER OUTER HT 9100 PK=10	536200	HEAD HARNESS BACK PART 9100		
169505	SWEATBAND 9100 & 9100 FX PK=5	422000	BATTERY LITHIUM 9100, 100 & 9000 PK=5	528025	LENS COVER INNER 9100XX PK=5	540500	FRONT COVER KIT 9100 FX		
169550	SWEATBAND 9100 & 9100 FX PK=50	500026	LENS WELDING 9100XXi SPEEDGLAS	531000	HOLDER BATTERY 9100	541800	HELMET WELDING 9100 FX EXC LENS		

ABN 21 060 672 979

TOOWOOMBA WELDING SUPPLIES



Ph: 07 4659 0044
500 Boundary Street, Toowoomba QLD 4350
E: sales@tweld.com.au | www.tweld.com.au

We deliver on time ... EVERYTIME
We are an Australian locally owned family business

Further information and advice

To request a quote or place an order for spare parts, please contact TWS on +61 (0) 7 4659 0044 or visit www.tweld.com.au. Please note that higher than normal levels of pollutants, heat and sparks will require more frequent replacement of components. If you require additional guidance, please check the care and maintenance videos on our YouTube Channel (www.youtube.com/user/3MSpeedglas) or contact your local TWS representative.