

3M™ Speedglas™ Welding Helmet 9002NC



To optimise the effective lifetime of your welding equipment and avoid the additional cost of replacement, regular maintenance is important. Replace all damaged parts immediately to ensure correct levels of protection.

Before use

- **Helmet and head harness.** Inspect for cracks or any damaged or defective parts. Replace if needed.
- **Cover lenses.** To provide the best possible vision they should be clean and without scratches.
- **Welding lens.** Ensure low battery is not flashing and check that the sensors are clean and uncovered.

After use

- **Clean the helmet.** Wipe with a moist tissue or cloth, both inside and outside the helmet. DO NOT rinse, immerse in water or clean with solvents.
- **Sweatband.** Remove for additional cleaning as needed and replace if it becomes unhygienic.
- **Cover lenses.** Clean with a soft cloth and replace if any pits or scratches occur.
- **Storage.** Store the helmet in a dry, clean area away from direct sunlight, high temperatures and solvents.

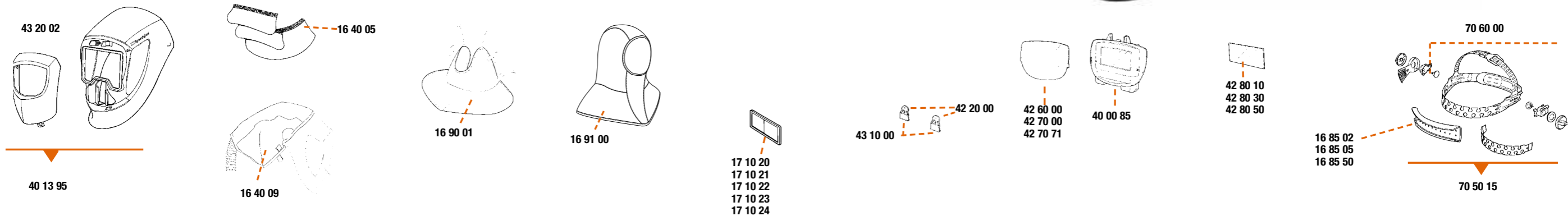

Part No	Description	Part No	Description	Part No	Description	Part No	Description
164005	THROAT PROTECTION LEATHER 100 & 9000	171020	LENS MAGNIFYING 1.0X 9100 100 & 9000	422000	BATTERY LITHIUM 9100, 100 & 9000 PK=2	431000	HOLDER BATTERY 9000 PK=2
164009	HEAD PROTECTION TECAWELD 100 & 9000	171021	LENS MAGNIFYING 1.5X 9100 100 & 9000	426000	LENS COVER OUTER STD 140C 9000 PK=10	432002	COVER FRONT 9002NC
168502	SWEATBAND 100 & 9100MP PK=2	171022	LENS MAGNIFYING 2.0X 9100 100 & 9000	427070	LENS COVER OUTER HC 145C 9000 PK=10	705015	HEAD HARNESS 100 & 9000
168505	SWEATBAND 100 & 9100MP PK=5	171023	LENS MAGNIFYING 2.5X 9100 100 & 9000	427071	LENS COVER OUTER HT 205C 9000 PK=10	706000	HEAD HARNESS ATTACHMENTS 100 & SL
168550	SWEATBAND 100 & 9100MP PK=50	171024	LENS MAGNIFYING 3.0X 9100 100 & 9000	428010	LENS COVER INNER 9002X PK=5		
169001	THROAT PROTECTION TECAWELD 100 & 9100 MP	400085	LENS WELDING 9002NC SPEEDGLAS	428030	LENS COVER INNER SH 1 9002X PK=5		
169100	HEAD CAPE TECAWELD	401395	SHELL EXC LENS 9002NC	428050	LENS COVER INNER SH 2 9002X PK=5		

ABN 21 060 672 979

TOOWOOMBA WELDING SUPPLIES

Ph: 07 4659 0044
500 Boundary Street, Toowoomba QLD 4350
E: sales@tweld.com.au | www.tweld.com.au

We deliver on time ... EVERYTIME
We are an Australian locally owned family business



Further information and advice

To request a quote or place an order for spare parts, please contact TWS on +61 (0) 7 4659 0044 or visit www.tweld.com.au. Please note that higher than normal levels of pollutants, heat and sparks will require more frequent replacement of components. If you require additional guidance, please check the care and maintenance videos on our YouTube Channel (www.youtube.com/user/3MSpeedglas) or contact your local TWS representative.